



701 The Queensway,
Peterborough, ON K9J 7J6
Email: Info@rockwoodkitchens.com
Phone: 705-486-0018
Fax: 1-866-722-1326

CLIENT INFORMATION

Date: _____ Name: _____
Phone: _____ Email Address: _____
Project Address: _____

Please fill in the blanks and/or circle any of the options that apply. (eg. Gas / Electric)

STRUCTURAL ELEMENTS:

Ceiling Height: _____
Bulkhead Height: _____
Do you plan on removing the bulkhead? _____

APPLIANCES DIMENSIONS

Stove:

Gas / Electric
Freestanding / Slide-In / Cooktop & Wall Oven

Ventilation:

Hood Vent / Chimney Hood / Microwave / Wood Hood

Fridge:

Width _____ Depth _____ Height _____

Microwave:

Width _____ Depth _____ Height _____

Over the Stove / On Counter / In a Wall Cabinet / In a Base Cabinet/ In a Tall Cabinet (Pantry or Wall Oven)

Dishwasher:

Beside Sink / Other _____

CABINET INFORMATION

Style: _____

UPPER CABINET HEIGHT:

30" / 36" / 42"

TRIM DETAILS

Crown / Crown to Ceiling / Staggered
Light Rail / Space Above / Window Valance

Extra notes on trim: _____

STORAGE/DETAILS

Preference for base cabinet storage:
Doors / Drawers

GLASS DOORS:

Location: _____
Type: _____

ACCESSORIES:

Please circle any of the features below you would like to include in your kitchen:

- Spice Pull Pantry
- Pot and pan drawers Cooking Tray Storage
- Open Shelves Roll Out Trays
- Wine Rack Waste Bin

ISLAND/PENINSULA:

How many people would you like to seat at your island or peninsula _____

Please circle any of the features below you would like to include:

- Deco Doors Baseboard Moulding Plain Panel
- Posts Corbels

COUNTERTOP MATERIAL:

Granite / Quartz

If there is a sample you like in the showroom, please write it down: _____

SINKS:

Big left Small Right / Equal Double / Apron or Farm Sink / Single Bowl / Special Order

Client will provide own sink: Yes / No

EDGE PROFILES:

¾" no built up edge

Built up edge (appears 1 ½" thick): Quarter Round / Pencil Round / Top Bevel / Top and Bottom Bevel

Upgraded Edge Profiles: Ogee / Waterfall

DOOR AND DRAWER PULLS:

Supplier: Berenson / Marathon

Code: _____

Code: _____

EXTRA NOTES:

You are also welcome to include photos of your current space as well as your inspiration photos. A great resource is www.houzz.com where you can create "idea books" and send us links to view kitchens and items you love. We look forward to helping you with your design!

Sincerely,

Your Rockwood Kitchens Design Team

RockWood Kitchens

SOLID WOOD CABINETS AT ROCK BOTTOM PRICES

45 Commerce Park Drive, Unit B

Barrie, Ontario L4N 8X1

Tel: (705) 881-1750 Fax: (705) 230-0419

Email: info@rockwoodkitchens.ca

Web: www.rockwoodkitchens.ca

DATE: _____

NAME: _____

TELEPHONE: _____

EMAIL: _____

CEILING HEIGHT: _____

BULKHEAD HEIGHT: _____

Please also include length of walls, size and location of windows and doors, and location of appliances. Please have dimensions in feet or inches.

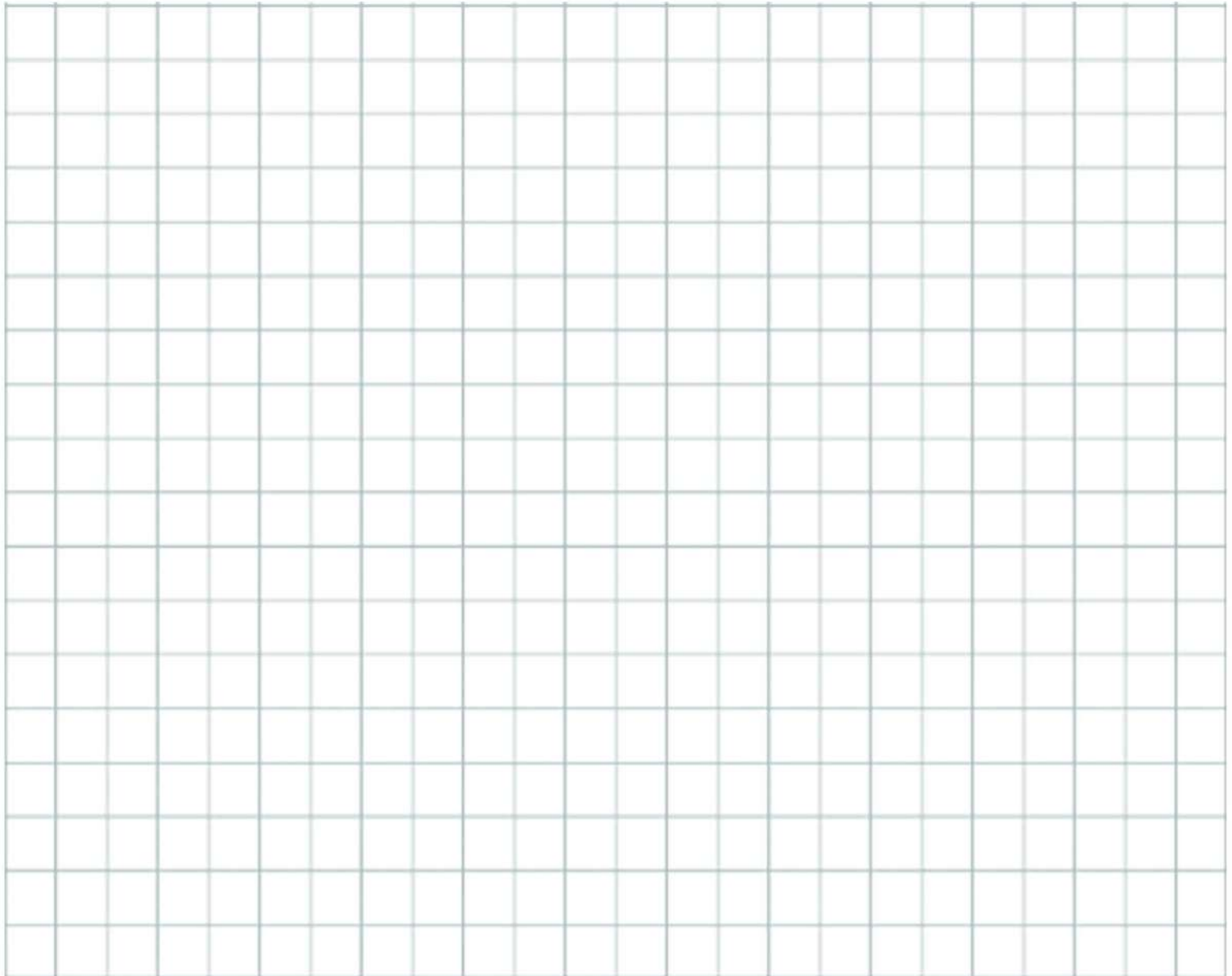
A large grid for drawing kitchen layouts, consisting of 20 columns and 20 rows of squares.

LEGEND

(STD) = STANDARD DOORWAY

(STO) = STOVE

(PLU) = PLUMBING/SINK

(OPD) = OUTSIDE PATIO DOOR

(FRG) = FRIDGE

(VEN) = EXHAUST VENT

(WIN) = WINDOW

(DISH) = DISHWASHER

(REG) = HEAT REGISTERS

RockWood Kitchens

SOLID WOOD CABINETS AT ROCK BOTTOM PRICES

45 Commerce Park Drive, Unit B

Barrie, Ontario L4N 8X1

Tel: (705) 881-1750 Fax: (705) 230-0419

Email: info@rockwoodkitchens.ca

Web: www.rockwoodkitchens.ca

DATE: _____

NAME: _____

TELEPHONE: _____

EMAIL: _____

CEILING HEIGHT: _____

BULKHEAD HEIGHT: _____

Please also include length of walls, size and location of windows and doors, and location of appliances. Please have dimensions in feet or inches.

-EXAMPLE-

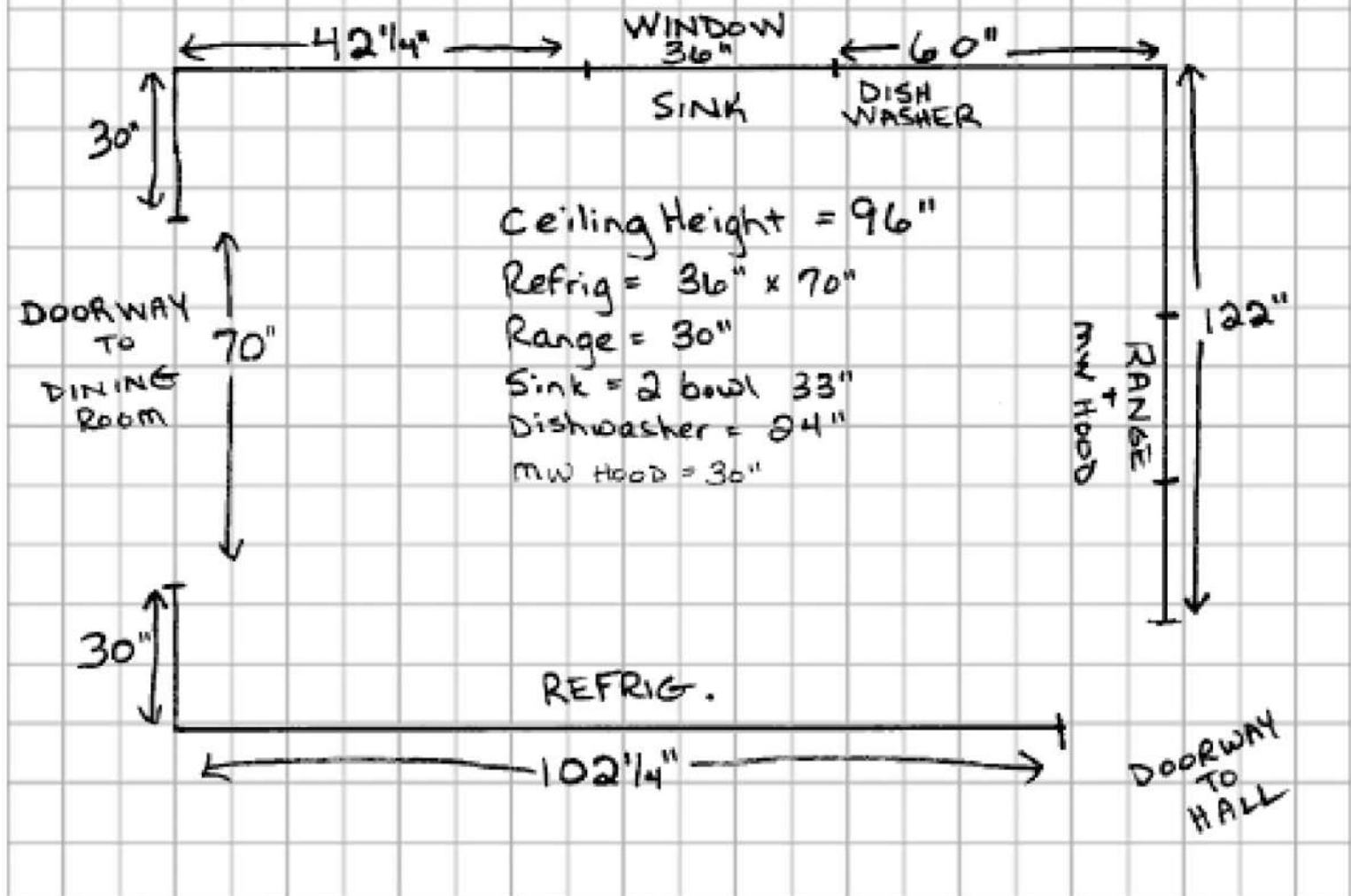

LEGEND

(STD) = STANDARD DOORWAY

(OPD) = OUTSIDE PATIO DOOR

(WIN) = WINDOW

(STO) = STOVE

(FRG) = FRIDGE

(DISH) = DISHWASHER

(PLU) = PLUMBING/SINK

(VEN) = EXHAUST VENT

(REG) = HEAT REGISTERS